

THE **398** PHYSICIANS
LOCAL DOCTORS TRUST

INSIDE:
NORTHWEST
HOME
BEAUTIFUL BATHROOMS

seattle

SMART. SAVVY. ESSENTIAL.

JULY 2011

TOP DOCS



PLUS:
THE NEW
STAND-
ALONE ERS
LIVING
WITH BREAST
CANCER
HOW TO CHOOSE
AN ANESTHESIOLOGIST

**ISLAND
DINING**
14 CAN'T-MISS
LOCAL TASTES
(PAGE 60)

URBAN RUINS:
RELICS OF
SEATTLE'S PAST
HOW BIKES
ARE GAINING
IN SEATTLE'S
ROAD WARS
THE BEST PLACES
TO BARTER

SEATTLEMAG.COM

\$4.99US \$5.99CAN

07



ZOLTAN FARKAS



CONSTRUCTION, LLC

www.ZoltanFarkasConstruction.com 206.769.7682

NORTHWEST HOME

JULY 2011

COTTAGE CUTE

A Phinney Ridge couple builds their down-sized dream house (tour it: July 17)



BATH SPLASH: TERRIFIC TUBS, SEXY SINKS, AND MORE!

nwhomemag.com

ZOLTAN FARKAS
A black silhouette of a hammer, positioned horizontally with the head to the right.
CONSTRUCTION, LLC

www.ZoltanFarkasConstruction.com 206.769.7682

Cottage Cute

TOUR THIS HOME

AIA Seattle // NW Home
 Open House of the Month
 Sunday, July 17
 Noon-3 p.m.
 See page 16 for details

A PHINNEY RIDGE COUPLE BUILDS THEIR
 DOWN-SIZED DREAM HOUSE

BY SHANNON O'LEARY
 PHOTOGRAPHY BY ED SOZINHO



"We've been the chief entertainment in the neighborhood," says Marilyn Widner with a smile as she and her husband, Ken, sit at the patio table situated in what quickly is taking shape as their new sidewalk-fronting garden. ■ The object of the neighbors' fascination is the couple's brand-new backyard cottage. ■ After 30 years in their 3,000-square-foot 1926 Phinney Ridge bungalow, in which they had raised two kids, the couple had begun to mull over retirement options. "We wanted to stay in the neighborhood, and were toying with the idea of putting a mother-in-law apartment in the basement [for ourselves]," recalls Ken. "But then we were thinking, 'Well, we don't really want to live our basement...'" ■ Enter the City of Seattle's newly amended Detached Accessory Dwelling Unit ordinance in 2009, which for the first time permitted the raising of backyard cottages in all of the city's single-home zones. "All of a sudden, we're reading about the city's passing this ordinance, and we just sort of jumped on it," recalls Ken. Not only did a cottage ideally suit their downsizing ambitions ("I don't need to clean 3,000 square feet of house



anymore," says Marilyn with a laugh), but the couple decided that by renting out their big house they could subsidize their new cottage and their retirement, which included plenty of travel plans. Matt Hutchins of Fremont's CAST architecture, as it happened, a lobbying force behind the cottage ordinance, soon arrived on the couple's corner lot ready to kick-start the trio's cottage industry. ■ Per his clients' desire, the architect delivered a diminutive dwelling, but one that didn't skimp on functionality, light or green space. Because his clients are die-hard gardeners, Hutchins' design incorporated a trellis on the cottage's exterior and a rainwater cistern which, for some nine months of the year, is expected to supply water for thirsty plants, as well as for washing laundry

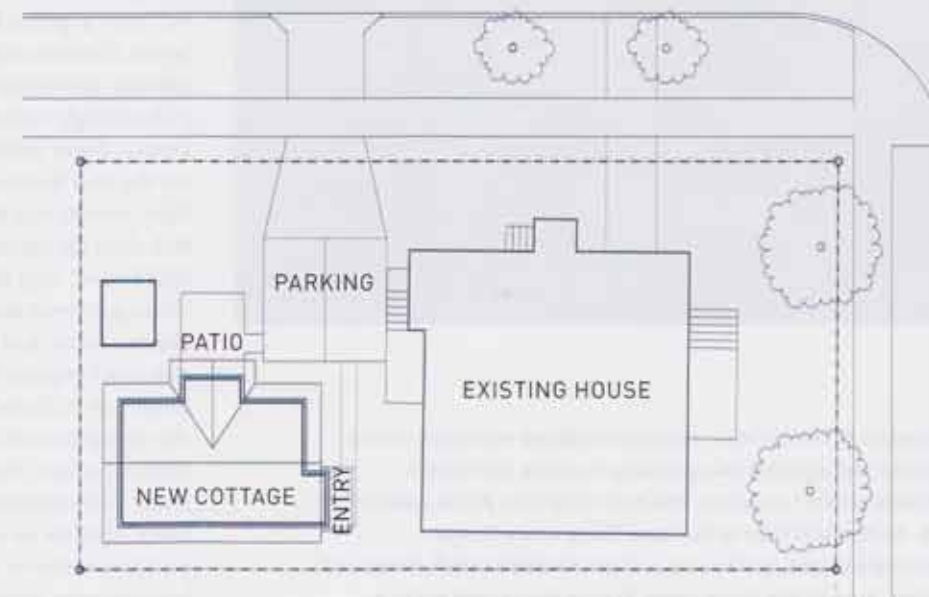

Clockwise from left: The new 800-square-foot, trellis-graced cottage in Phinney Ridge is practical and surprisingly spacious. Homeowner Ken Widner (left) patio-side with his cottage architect Matt Hutchins. Sharing the same lot as their new cottage, is the Widners' 3,000-square-foot original home, which the couple intends to rent out to subsidize their retirement.



Clockwise: Architect Matt Hutchins designed this space-savvy staircase storage system especially to house his client's extensive album collection. The colorfully cute petite powder room. On the first floor is the main living space that is becomingly bright, and boasts radiant-heated bamboo hardwood flooring. Just off the living room, French doors lead out to a favored spot of the homeowners: a new front garden bearing a number of transplanted plantings from their original big garden.

and flushing toilets. ■ Hutchins was very mindful that the cottage fit seamlessly into the neighborhood. Explains Marilyn, "One of the first things we said is, 'Our house has been here since 1926, so Matt, we want this [new] one to look like it's been here almost as long.'" Fortunately, to make room for the two-story cottage, all Hutchins had to do was to tear down a large dilapidated deck attached to the back of the main house (the new cottage's living room windows are set where that deck once ended), and it was a perfect fit. "The other houses [on the street] are on narrow lots too and so this one just kind of pops right in," says a pleased Hutchins. ■ The cottage's interior layout is necessarily simple, with the first floor featuring a bright, invitingly open main living space that includes a charmingly compact kitchen, pretty powder room and French doors leading out to the garden patio. Upstairs are the two bedrooms and a master bath, and plenty of light, thanks to a sky-light studded vaulted ceiling. "We had all of the constraints of size and budget, but what we didn't have," says Hutchins, "was a constrained program. These guys were as ambitious as with a giant custom house project. So we had to get all that sort of special-ness into this tiny footprint. I think that the finite aspect of the size caused us to focus on what's really important." One of the cottage's most important focal points is the signature shelving system that Hutchins built into the staircase to house Ken's impressive album collection. "What would be just a staircase in another house," explains Hutchins, "is an opportunity to make up the furniture that you're not bringing over from the old house, and it has to do double and triple duty." ■ The Widners say that the hardest part of downsizing has been sifting through a lifetime's worth of belongings, and deciding which items (from furniture to their kids' school projects) should be cottage-bound and which they simply should let go. ■ Happily, they are in no doubt that their cottage built for two is a keeper. ✦

Although compact, the kitchen, sporting slate countertops and hidden swing-out storage bins inside its cabinets, is more than big enough to accommodate two passionate cooks.

Puget Galleries

ANTIQUE MALL &
AUCTION HOUSE

1000 1st Avenue
Seattle, WA 98101
206.462.1000

241 South Lake Street, Seattle
206.292.3000 • www.Puget.com

This beautiful room
didn't design itself.

Yes, the furniture from Masins is a wonderful start, but it takes one of our talented designers to put it all together. Come visit us soon!

Decorative lighting, decorative mirrors, chairs, ottomans, dining room and bedroom furniture, and more decorative items. Check our website for special sale prices.

www.masins.com • 206.462.1000 • 1000 1st Avenue, Seattle, WA 98101

MASINS

Decorative Lighting • Mirrors • Furniture • More

ZOLTAN FARKAS

CONSTRUCTION, LLC

www.ZoltanFarkasConstruction.com 206.769.7682

aia seattle

NORTHWEST HOME

AIA SEATTLE // NW HOME

OPEN HOUSE

Edition 7 :: Number 38

Architectural Firm :: CAST architecture

Cost :: Approximately \$300 per square foot for an 800-square-foot house

(total project cost might include additional fees for other services that are not reflected).

Tour it :: Sunday, July 17

(see details below)

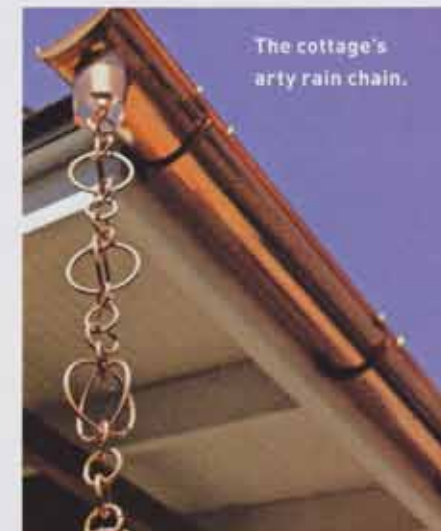

The cottage's arty rain chain.

Open House Tour

Our ongoing partnership with the American Institute of Architects Seattle Chapter (AIA Seattle) continues our commitment to bring the experience of Puget Sound-area residential design to our readers. Each issue, we showcase an architect-designed home, selected by AIA Seattle and Northwest Home, which will be open to the public for a Sunday-afternoon viewing. We invite you to tour this issue's featured home, designed by Matt Hutchins of CAST architecture, located in Phinney Ridge at 558 N 70th St., on Sunday, July 17, between noon and 3 p.m. For more information on the tour and the Open House program, visit nwhome.com or aiaseattle.org; 206.448.4938.

FIND IT



PRODUCT AVAILABILITY AND PRICES SUBJECT TO CHANGE.

HOME OF THE MONTH Cottage Cute Page 12

Architect: Matt Hutchins, CAST architecture, 115-C N 36th St., Seattle, 206.256.9886; castarchitecture.com. **General contractor:** Zoltan Farkas, Zoltan Farkas Construction, 206.769.7373; zoltanfarkasconstruction.com. **Plumbing, cistern plumbing, radiant heat systems:** Good Services Plumbing & Heating, Seattle, 206.322.3000; goodservices.com. **Electrical:** Lazlo Farkas, Laz Electric, Seattle, 206.417.3465; lazelectric.com. **Drywall:** Darrell Konkler, American Wall, Marysville, 425.766.3372; manta.com/c/mm3n06f/american-wall. **Bamboo flooring:** Advanced Floor Designs, 7023 NE 175th St., No. F, Kenmore, 425.481.5195. **Interior/exterior painting:** Gustavo Garcia, Citivel Painting, Inc, Seattle, 206.949.1036. **Powder room sink/faucet:** Seattle Interiors, 3822 Stone Way N, Seattle, 206.633.2900; seattleinteriors.com. **Bath tiles:** Seattle Tile Company, 7716 15th Ave. NW, Seattle, 206.782.1985; seattletile.com. **Kitchen backsplash:** Seattle Tile Company. **Master bath (farm sink, toilets, towel racks, hardware):** Morgans Electrical & Plumbing, 3627 Stoneway Ave. N, Seattle, 206.547.1617; morgamonline.com. **Counters:** slate kitchen counter, marble bath counter, Jimmy Mai, Allied Marble, 5219 Fourth Ave. S., Seattle, 206.763.1250; alliedmarbleinc.com. **Cabinetry (kitchen/dining room):** Wally Meyer, Pioneer Woodworks, 12337 Lake City Way NE, Seattle, 206.362.5637. **Appliances:** Mark Ferrier, Albert Lee, 1476 Elliott Ave. W, Seattle, 206.282.2110; albertleecappliance.com. **Built-in staircase entertainment center:** Design by Matt Hutchins, bamboo plywood from Bamboo Hardwoods, 6405 Roosevelt Way NE, Seattle, 206.529.0978; bamboohardwoods.com. **Rainwater cistern:** Mike Broili, Living Systems Design, 211 NW 201 St., Shoreline, 206.546.3119; harvestrain.net. **Light fixtures:** David Chin, Harold's Lighting, 1912 N 45th St., Seattle, 206.219.4341; haroldslighting.com. **Powder room mirror, dining room table, chairs:** Antika, 8421 Greenwood Ave. N, Seattle, 206.789.6393; antikaanriques.com. **Farm doors:** Frank Lumber, The Door Store, 17727 15th Ave. NE, Shoreline, 206.362.2311; franklumberthedorstore.com. **Door hardware:** Builders' Hardware & Supply Company, 1516 15th Ave. W, Seattle, 206.281.5700; buildershardware.com. **French doors, windows:** Marvin Windows and Doors, marvin.com. **Metal garden fences:** Home and Garden Art, 1111 NW 85th St., Seattle, 206.784.1080; homeandgardenart.com. **Landscape plantings:** Swansons, 9701 15th Ave. NW, Seattle, 206.782.2543; swansonsnursery.com. +



An International Art Gallery

ART STUDY
A NETWORK
OF NORTHWEST ARTISTS

241 South Lake Street, Seattle
206.292.3000 • www.Puget.com

1000 1st Avenue
Seattle, WA 98101
206.462.1000

1000 1st Avenue
Seattle, WA 98101
206.462.1000

1000 1st Avenue
Seattle, WA 98101
206.462.1000

1000 1st Avenue
Seattle, WA 98101
206.462.1000

1000 1st Avenue
Seattle, WA 98101
206.462.1000

1000 1st Avenue
Seattle, WA 98101
206.462.1000

1000 1st Avenue
Seattle, WA 98101
206.462.1000

1000 1st Avenue
Seattle, WA 98101
206.462.1000

1000 1st Avenue
Seattle, WA 98101
206.462.1000

1000 1st Avenue
Seattle, WA 98101
206.462.1000

1000 1st Avenue
Seattle, WA 98101
206.462.1000

1000 1st Avenue
Seattle, WA 98101
206.462.1000

1000 1st Avenue
Seattle, WA 98101
206.462.1000

1000 1st Avenue
Seattle, WA 98101
206.462.1000

1000 1st Avenue
Seattle, WA 98101
206.462.1000

1000 1st Avenue
Seattle, WA 98101
206.462.1000

1000 1st Avenue
Seattle, WA 98101
206.462.1000

RAGEN
& Associates

1000 1st Avenue
Seattle, WA 98101
206.462.1000

1000 1st Avenue
Seattle, WA 98101
206.462.1000

1000 1st Avenue
Seattle, WA 98101
206.462.1000

1000 1st Avenue
Seattle, WA 98101
206.462.1000

1000 1st Avenue
Seattle, WA 98101
206.462.1000

1000 1st Avenue
Seattle, WA 98101
206.462.1000

1000 1st Avenue
Seattle, WA 98101
206.462.1000

1000 1st Avenue
Seattle, WA 98101
206.462.1000

1000 1st Avenue
Seattle, WA 98101
206.462.1000

1000 1st Avenue
Seattle, WA 98101
206.462.1000

1000 1st Avenue
Seattle, WA 98101
206.462.1000

1000 1st Avenue
Seattle, WA 98101
206.462.1000

1000 1st Avenue
Seattle, WA 98101
206.462.1000

1000 1st Avenue
Seattle, WA 98101
206.462.1000

1000 1st Avenue
Seattle, WA 98101
206.462.1000

1000 1st Avenue
Seattle, WA 98101
206.462.1000

1000 1st Avenue
Seattle, WA 98101
206.462.1000

1000 1st Avenue
Seattle, WA 98101
206.462.1000

1000 1st Avenue
Seattle, WA 98101
206.462.1000

1000 1st Avenue
Seattle, WA 98101
206.462.1000

1000 1st Avenue
Seattle, WA 98101
206.462.1000

1000 1st Avenue
Seattle, WA 98101
206.462.1000

1000 1st Avenue
Seattle, WA 98101
206.462.1000

1000 1st Avenue
Seattle, WA 98101
206.462.1000

1000 1st Avenue
Seattle, WA 98101
206.462.1000

1000 1st Avenue
Seattle, WA 98101
206.462.1000

1000 1st Avenue
Seattle, WA 98101
206.462.1000

ZOLTAN FARKAS

CONSTRUCTION, LLC

www.ZoltanFarkasConstruction.com 206.769.7682